

SOREX Bluetooth door handle (with pin code)

Quick Starting Guide

This quick starting guide will show how to set up the SOREX Bluetooth door handle with pin code. More Information can be received on our website www.sorex.eu, by contacting our support via e-mail support@sorex.eu or via phone +43 676 7755708.

Content

Smart handle	1 set
Escutcheons	2 pieces
CR2 batteries	2 pieces
Hex key	1 piece
Self-tapping screws	10 pieces
Connection screws M4x55	2 pieces
Connection screws M4x65	2 pieces

Installing the handle on the door

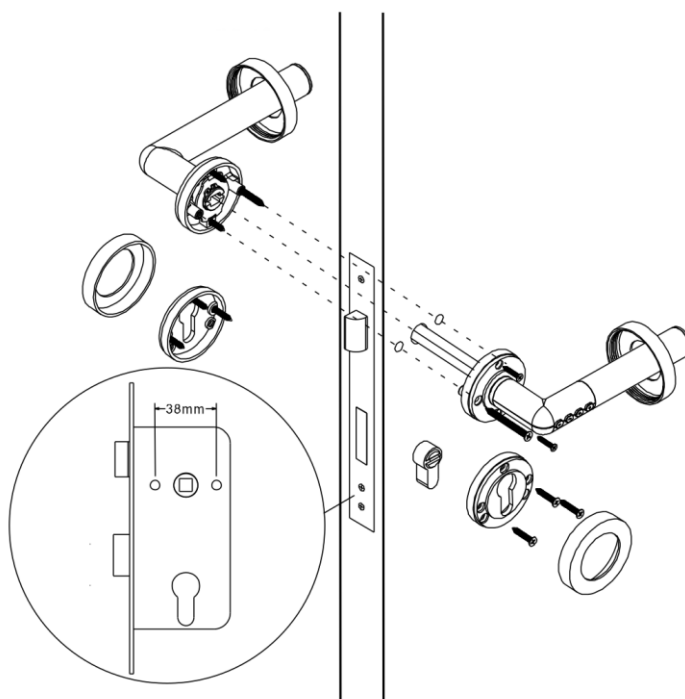

Figure 1: Installation of the handle

Please note: Before the installation you need to determine the door thickness. For doors with a thickness between

- 38-48mm please use the M4x55 screws
- 48-58mm please use the M4x65 screws

- For the installation of the door handle place the screws like shown in *Figure 1* and screw them down.
Please note: Always leave the door open during the installation!

Changing the batteries

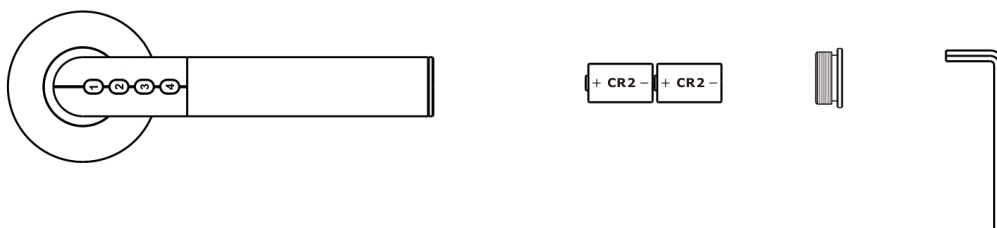

Figure 2: Changing the batteries

- To change the batteries open up the lid at the end of the handle with the enclosed hex key and insert the batteries like shown in *Figure 2*.

LED-signals

LED-Status	Product-Status
Green LED flashes	Unlock in normal mode
Red LED flashes	Unlock in low power mode
Green LED shines constantly	Waiting for pin code to be entered in normal mode
Red LED shines constantly	During pairing process or waiting for pin code to be entered in low power mode

Caution: If the LED on the door handle or the app indicate the **Low-Energy-Warning** you do have about 50 unlocks left. **Please change the batteries as soon as possible!**

Please note: After changing the batteries the administrator needs to unlock the handle via the app one time to unlock the cylinder for normal use. The set permissions get not deleted!

Setup on your smartphone

- To download the app either scan the QR-code or search for *Janus Lock* in the App Store on Apple or Play Store on Android smartphones.
- Either login to the app or – if you're using it for the first time – create an account.
- Before the setup enable Bluetooth and GPS on your smartphone.
- Click on the **+**-Symbol to add the door handle in the app and press any button on the handle.
- Select door and choose Name & Symbol.



Please note: The smartphone that connected with the handle for the first time automatically gets the administrator rights.

Operation of the app

- **Unlock now**
With this option you can open the handle via the app - if the smartphone is in range.
- **Battery status**
When your smartphone is in range this shows how much charge the batteries of the handle have left.
- **Use as a normal handle**
If this option is active you don't need any code input at the handle, it can be used as any other normal handle to open the door.
- **Access Right**
 - Email or Account no
Here you are able to invite already registered users of the app via E-mail or their account number to give them access rights. The invited user can then activate the handle by clicking *Unlock now* in the app.
Select *Add* in the section Access Right and click on *Invite by Email or Account no*. Type in the E-mail or account number and *Continue*. In the next step you can choose between different permission levels:
 - Passcode
With this option you can create a passcode for the handle with a minimum of 4 digits. The users that know this code can activate the handle by typing in the passcode at the handle.
To create a passcode select *Create Passcode* in the section Access Right in the app. Choose permission level (described in point *Email or Account no*). Now create a passcode (4 digits minimum) by clicking *Create access code*.
 - 1-day-Passcode
Enables to give access for a single day. The users that know this code can activate the handle by typing in the passcode at the handle.
In the section Access rights click *Generate One-day-passcode*. Next you choose the desired day to give access to the handle and press *Continue*. Afterwards you see a generated passcode which you can send to the person you want to grant access via clicking Copy and messaging them.
- **Unpair**
By unpairing your phone you can grant another smartphone admin access on the handle.
Please note: All codes and permissions get deleted!